

Making a Twinkle robot

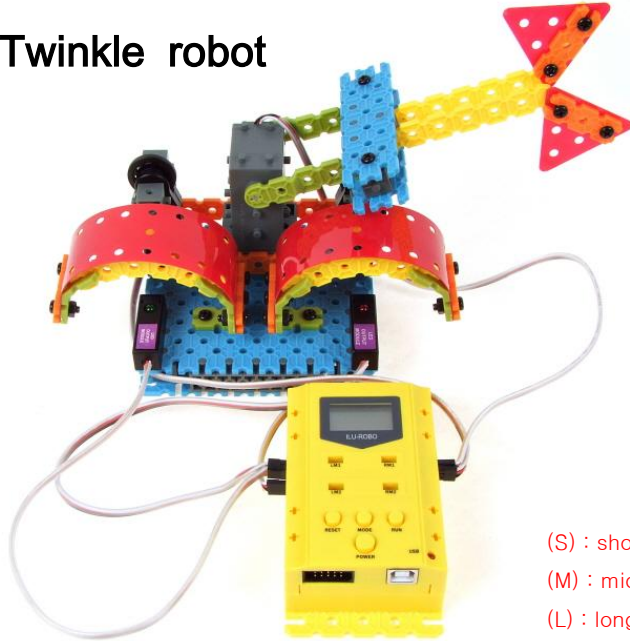

(S) : short
(M) : middle
(L) : long

1

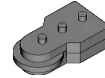
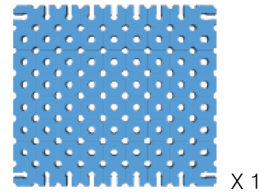

Touch sensor X 1

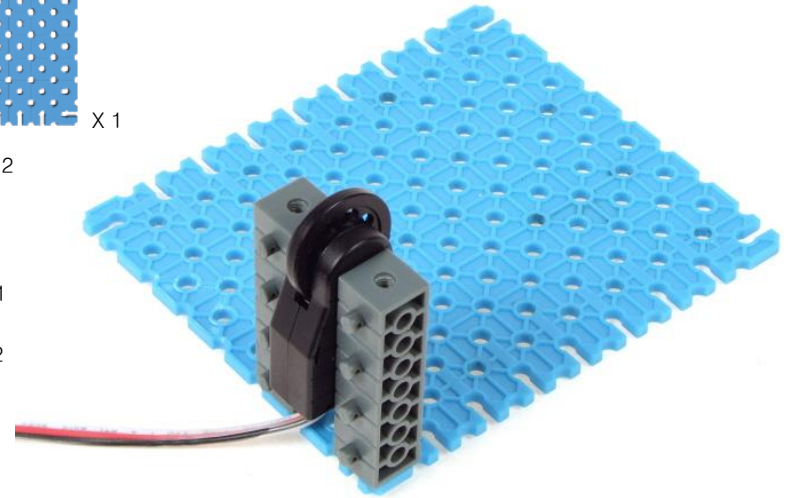

2

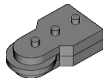

Touch sensor X 1

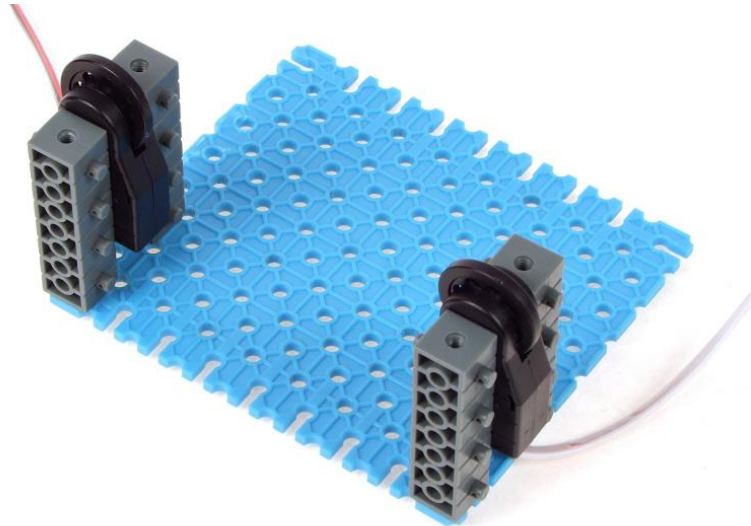

3

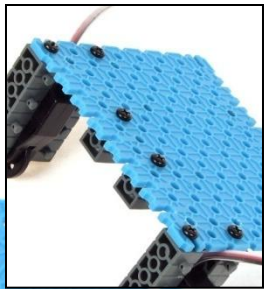
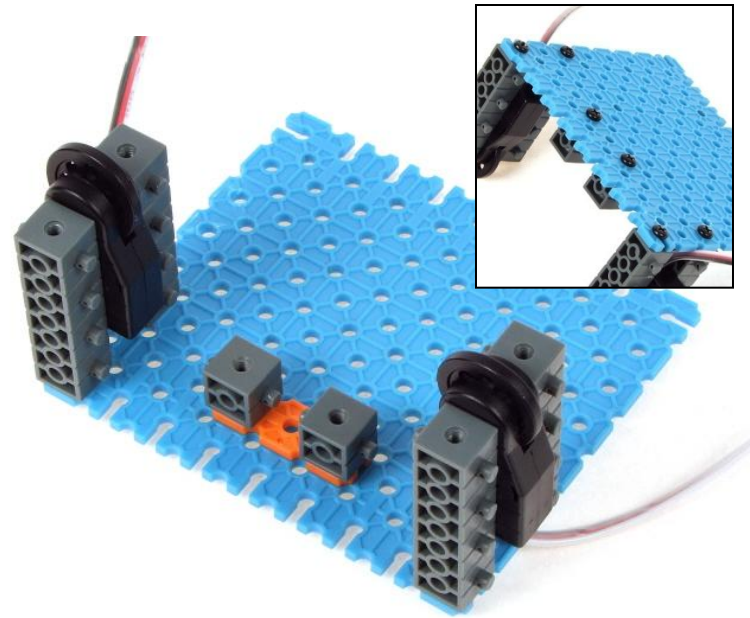

4

3000000 X 2

00000 X 2

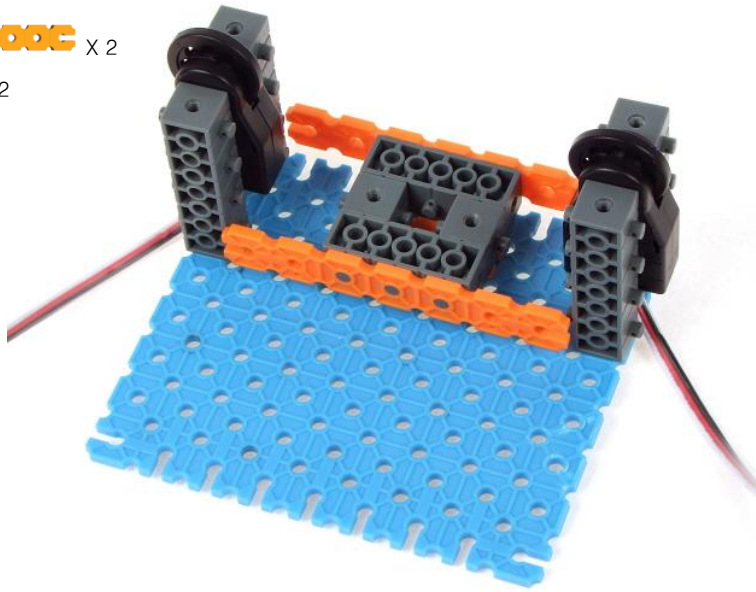

5

Red Technic beam (1x11) X 1

Yellow Technic chain link X 1

Green Technic L-connector X 2

Orange Technic axle (3 holes) X 1

Grey Technic screw (L) X 1

Grey Technic nut X 1



6

Green Technic L-connector X 1

Grey Technic screw (L) X 1

Grey Technic nut X 1



7

Yellow Technic chain link X 1

Green Technic L-connector X 2

Grey Technic screw (L) X 1

Grey Technic nut X 1

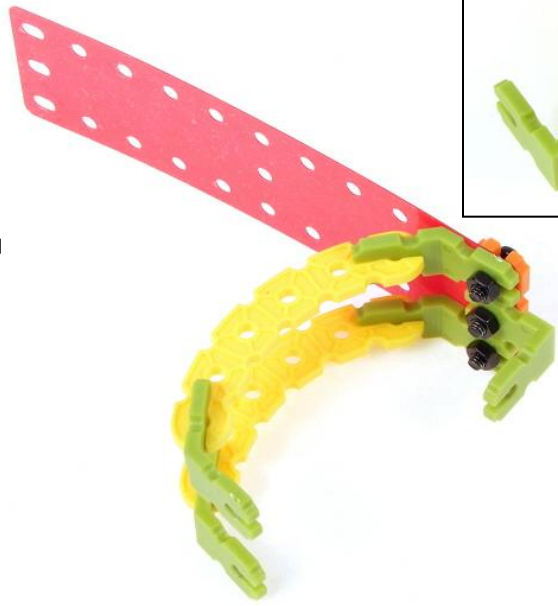
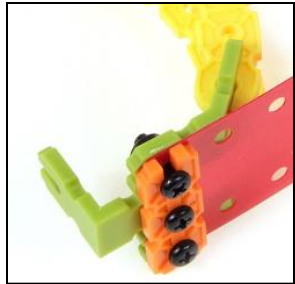

8

- (L) X 1
- X 1

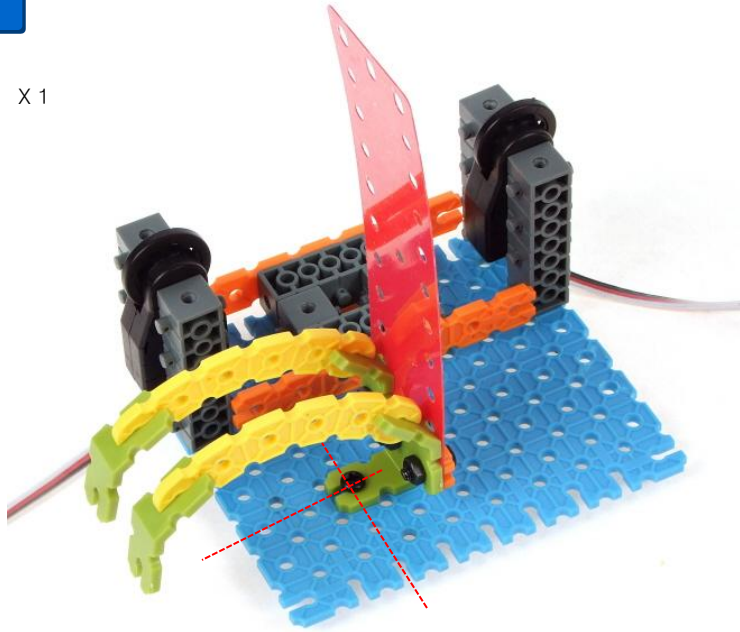

9

- X 1
- (L) X 2
- X 2

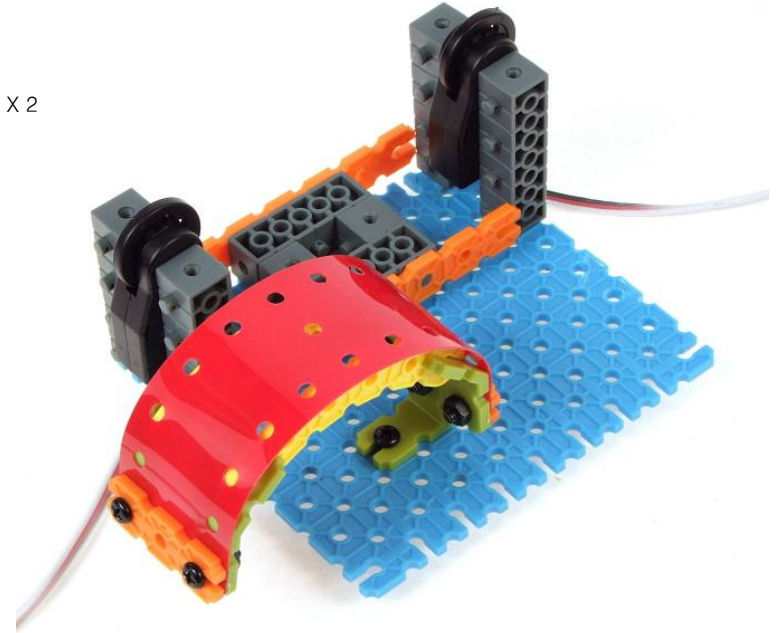

10

- X 1
- X 2
- X 1
- X 4
- X 1
- (L) X 3
- X 3





11

- X 1
- (L) X 3
- X 3





12

-  X 2
-  X 1
-  X 2

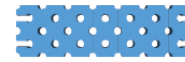

13



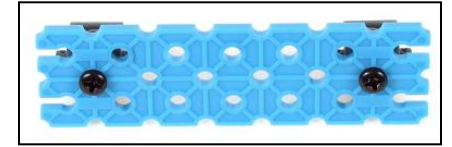

-  X 1
-  X 2
-  X 2



14

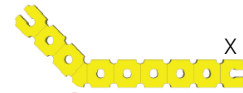

15

-  X 2
-  X 2
-  X 2
-  X 4
-  X 4

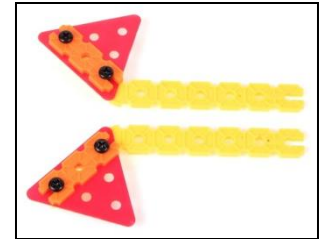

16

(S) X 2

X 1



17



18

X 1

(S) X 2



19

X 1

X 2

X 2

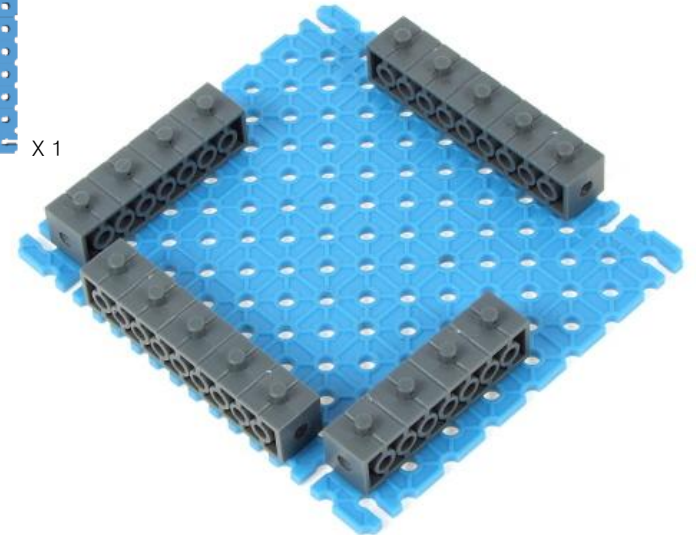

20

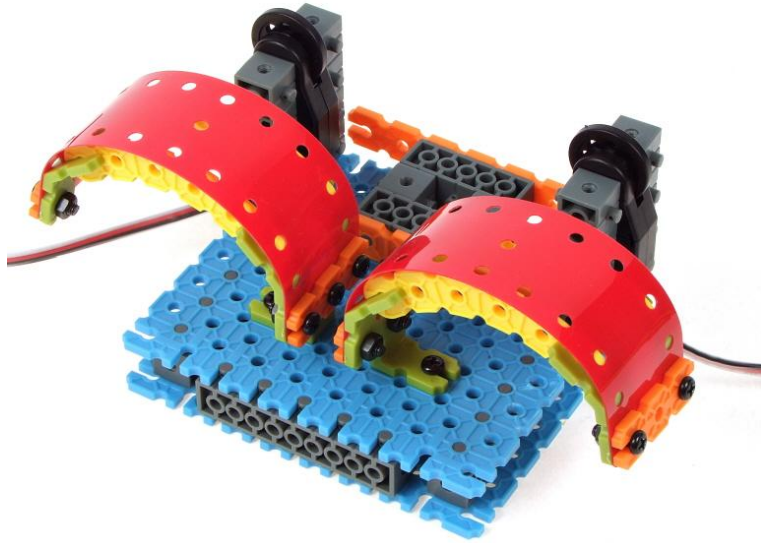

21



Servo motor X 1

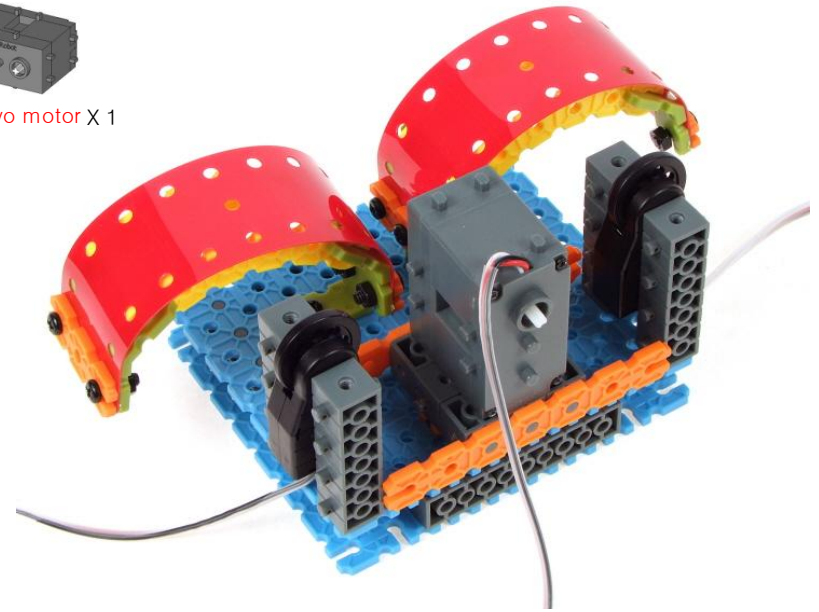

22

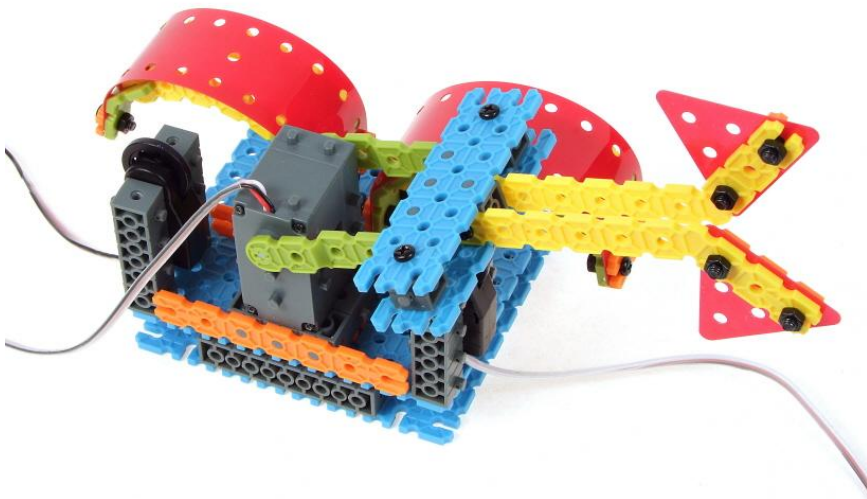

23



LED(G) X 1



LED(R) X 1

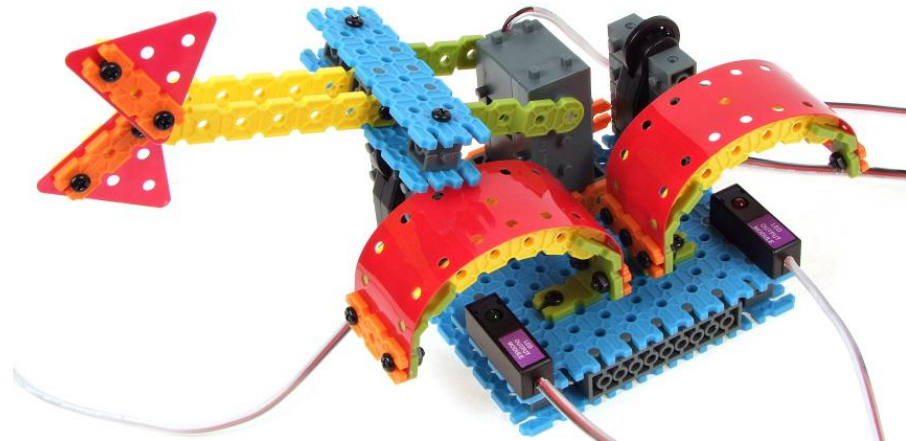

END

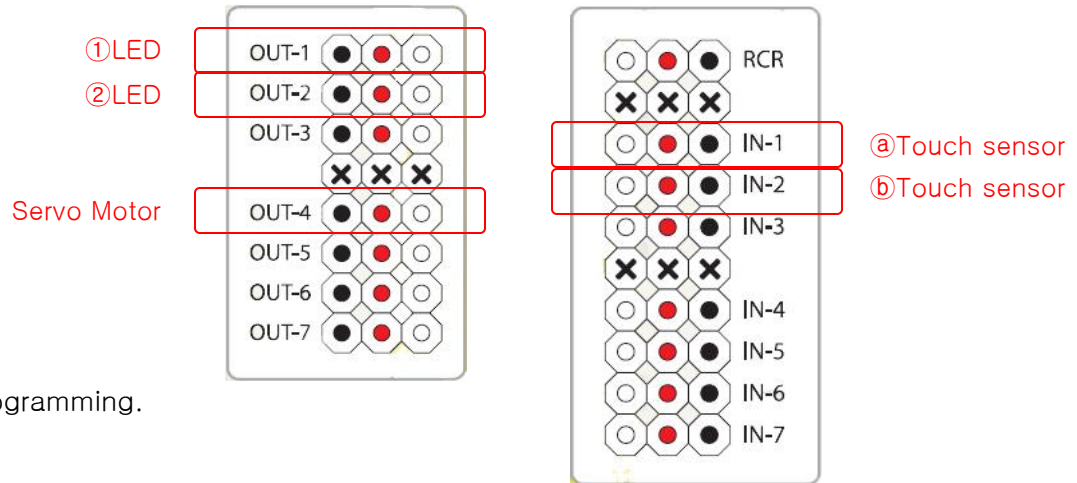
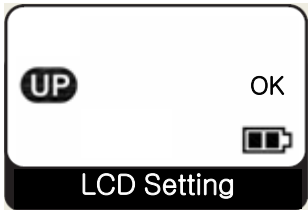
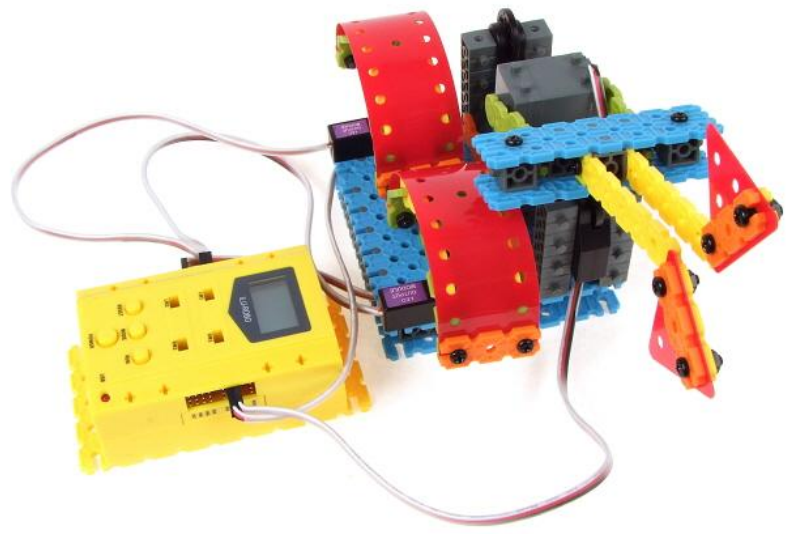

- This twinkle robot is for exercising the servo motor programming.
- Input module : 2 touch sensor
- Output module : 1 servo motor, 2 LED module
- About the EQ-ROBO program algorithm, please refer to another manual.

Part List of a Twinkle robot

